

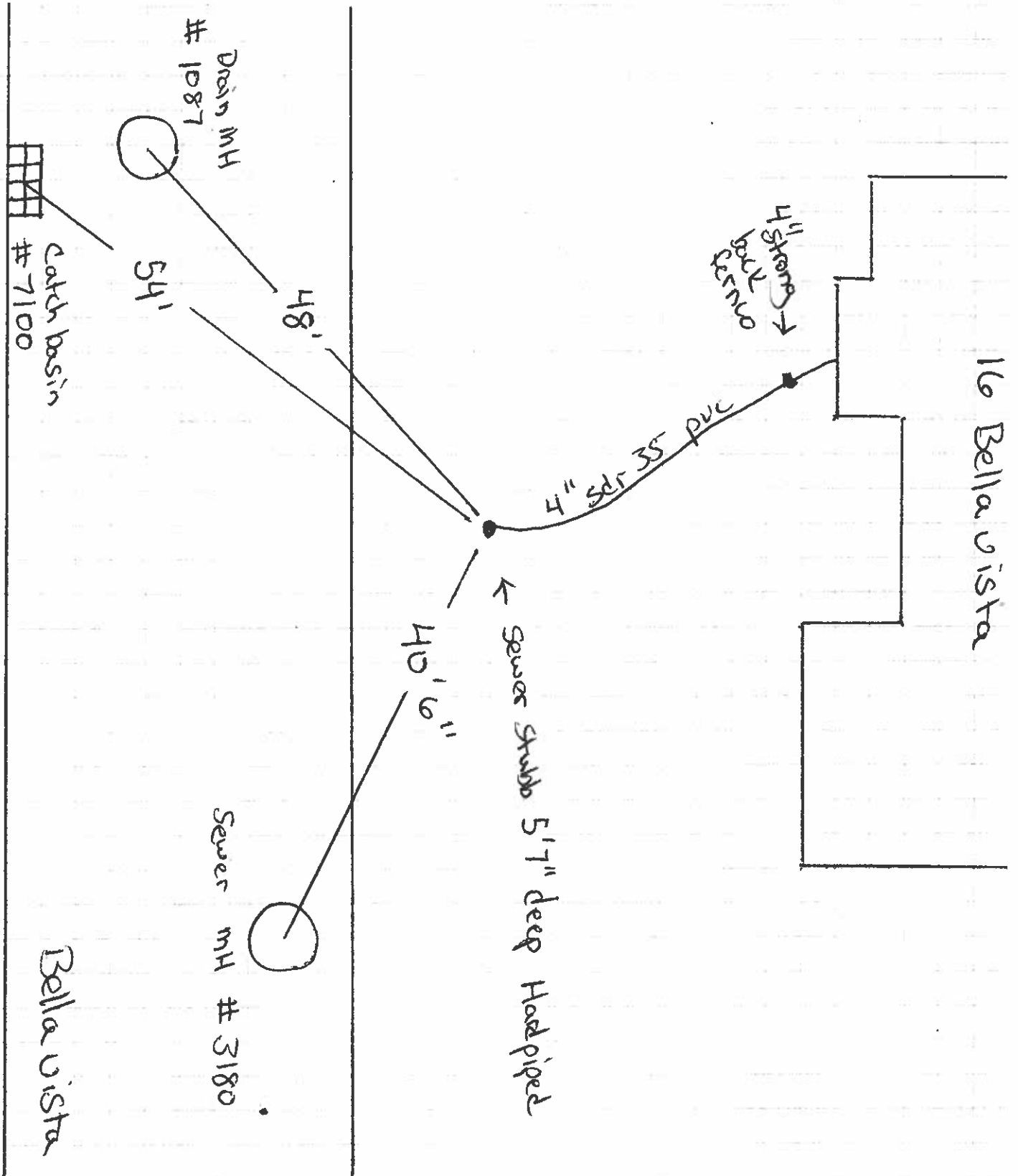

EAST LONGMEADOW DEPARTMENT OF PUBLIC WORKS

Job: 16 Bella Vista (Sewer)
Sheet No: Excavator - Skinner Const. of _____
Calculated By: Pope Date 9-15-21
Scale: _____



**TOWN OF EAST LONGMEADOW, MA
DEPARTMENT OF PUBLIC WORKS
SEWER INSPECTION**

DATE: 9-15-21

<u>Sanitary</u>	Storm	Other	Size 4" pvc
Fee	<u>\$50.00</u>		Inspected

LOCATION OF PROPERTY: 16 Bella Vista

OWNER:

Is drain under cellar floor

Feet above cellar floor

If building has cellar or footing drains, where do they discharge:

The above fee is for the initial inspection. If initial inspection is not approved, there will be an additional fee of \$25.00 for each inspection.

It is understood that only sanitary waste is to be connected to the sanitary sewer and only clean surface or sub-surface water to storm drain.

Thomas Pope
DPW Inspector