



# EAST LONGMEADOW DEPARTMENT OF PUBLIC WORKS

Job: # 17 CONCORD Drive

Sheet No: \_\_\_\_\_ of \_\_\_\_\_

Calculated By: FOIS Date 09/10/20

Scale: Feet

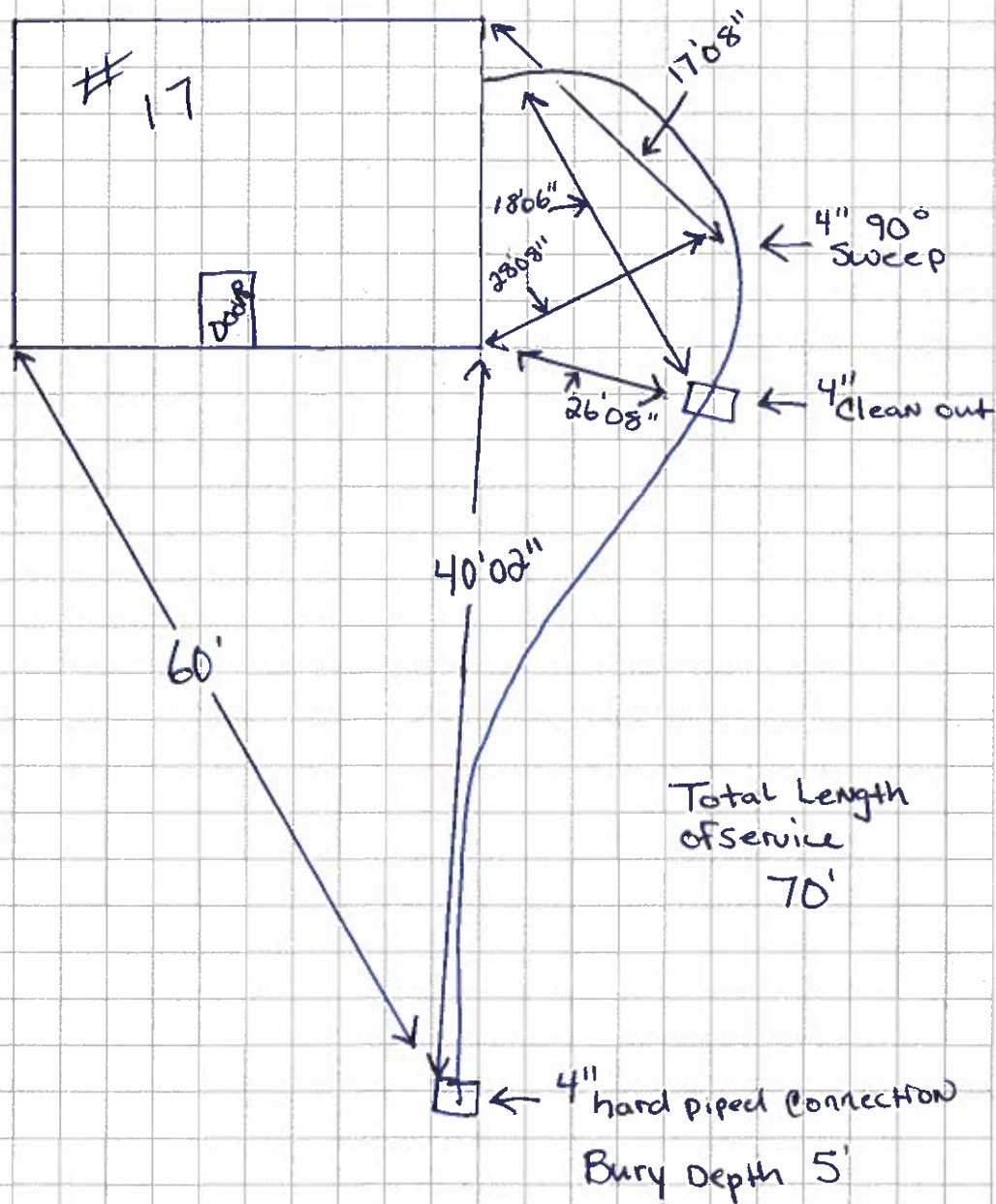



TOWN OF EAST LONGMEADOW  
DEPARTMENT OF PUBLIC WORKS  
60 CENTER SQUARE  
EAST LONGMEADOW, MA 01028

**Felix S. Vachon**, Water & Sewer Administrator

*felix.vachon@eastlongmeadowma.gov*  
(413) 525-5400 ext. 1204

September 10, 2020

Re: 17 Concord Drive

To whom it may concern,

The Property located at 17 Concord Drive has connected to the Town's Sanitary Sewer System. The septic tank was pumped and crushed. A new 4" PVC pipe was laid to the Town's connection point at the property line. All aspects of the above were inspected by the Town inspector and approved.

Regards,

Felix Vachon  
Water and Sewer Administrator  
Town of East Longmeadow Public Works



## Hampden Septic, Inc.

100 Main Street • Hampden, MA 01036

413-566-2916 • fax 413-566-2965

### Customer

Name Gary T  
Address #17 Concord Dr.  
City E. Long State MA ZIP 01028  
Phone \_\_\_\_\_

Rep: Billy Bond

Date	Description	Price
9/10/20	Pump out tank for sewer connection.	
	Send reminder in _____ year(s) Please keep this receipt for your records	on account

### Payment Details

- ☐ Cash  
☐ Check

Total

Not responsible for any damage to sprinkler lines or heads  
incurred during excavation. A charge of 1 1/2% per month, 18%  
per annum will be added to accounts over 30 days.

Thank you for choosing Hampden Septic, Inc.!