

# EAST LONGMEADOW DEPARTMENT OF PUBLIC WORKS

Job: ~~3~~ Jeffrey lane (Sewer) Forced Sewer  
Sheet No: Excavator - Bousquet of \_\_\_\_\_  
Calculated By: Pope Date 9-20-2021  
Scale: \_\_\_\_\_

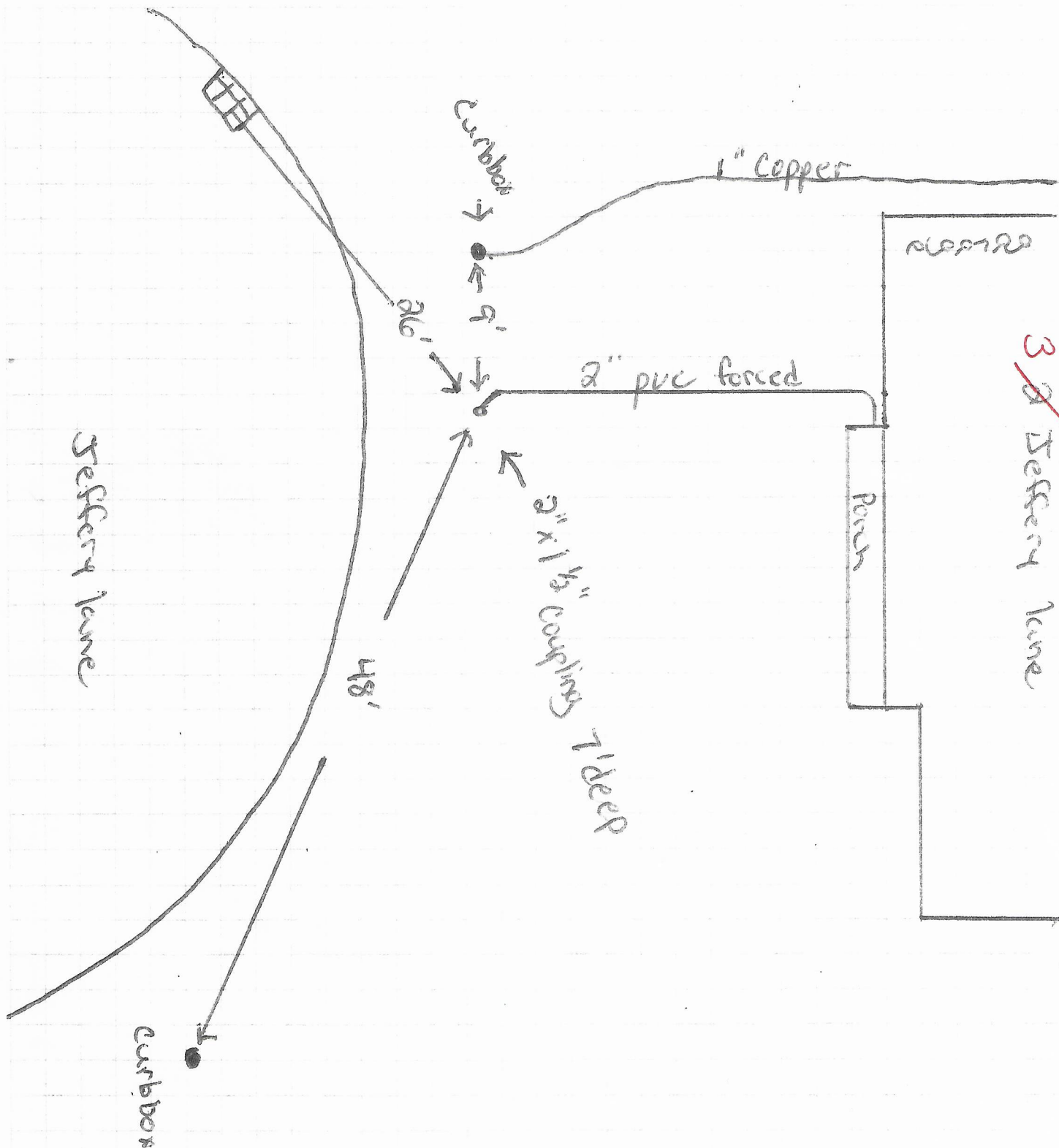

**TOWN OF EAST LONGMEADOW, MA  
DEPARTMENT OF PUBLIC WORKS  
SEWER INSPECTION**

DATE: 9-20-21

Sanitary

Storm

Other

Size

2" forced

Fee \$50.00

Inspected

yes

LOCATION OF PROPERTY:

<sup>3</sup> ~~2~~ Jeffery lane

**OWNER:**

Is drain under cellar floor

Feet above cellar floor

If building has cellar or footing drains, where do they discharge:

The above fee is for the initial inspection. If initial inspection is not approved, there will be an additional fee of \$25.00 for each inspection.

It is understood that only sanitary waste is to be connected to the sanitary sewer and only clean surface or sub-surface water to storm drain.

Thomas W. Pope

DPW Inspector