

EAST LONGMEADOW DEPARTMENT OF PUBLIC WORKS

Job: 30 Old Pasture DR.

Sheet No: Excavator - Holcomb Farms

Calculated By: Josh C

Date 5-9-2022

Scale: _____

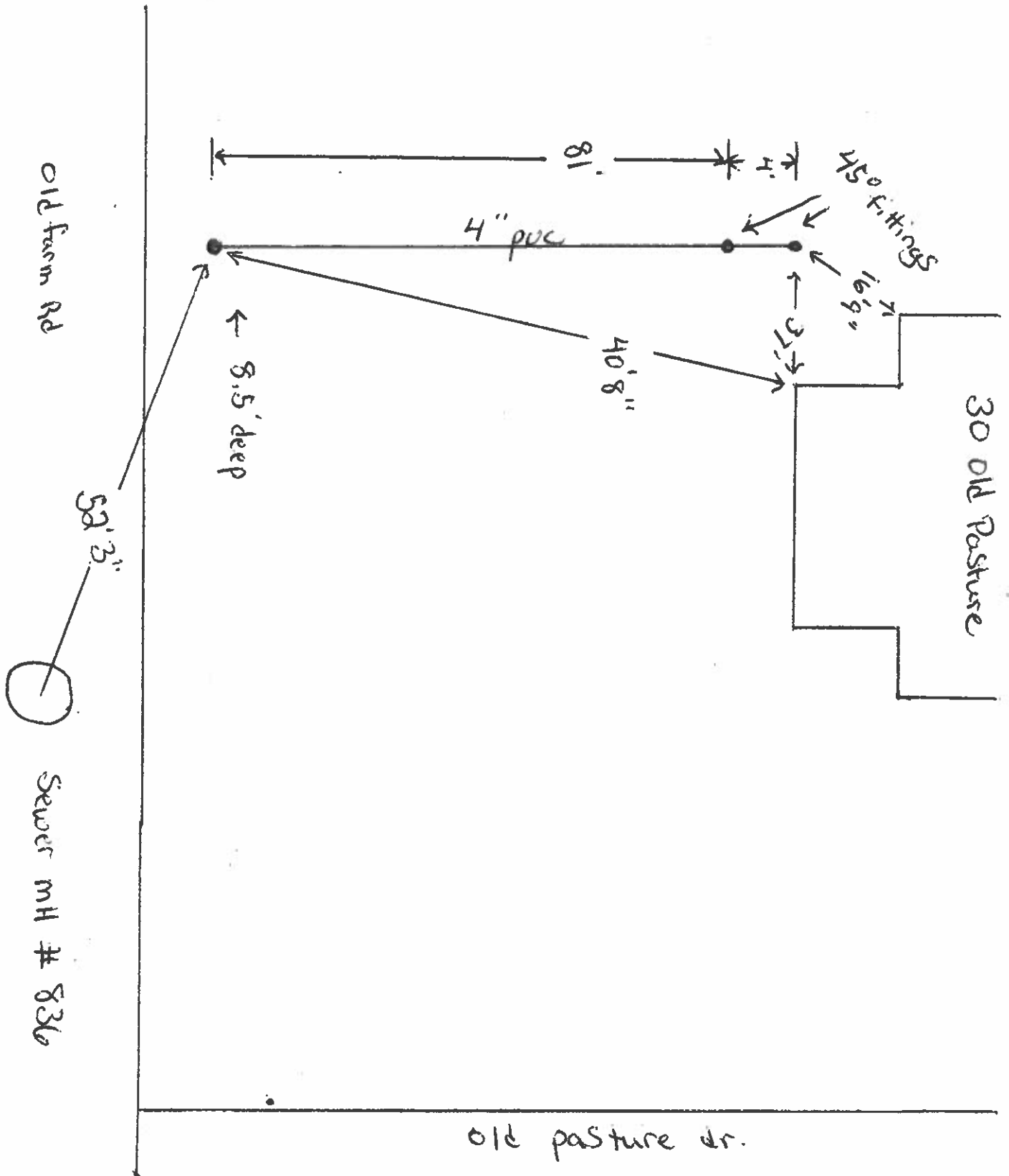

**TOWN OF EAST LONGMEADOW, MA
DEPARTMENT OF PUBLIC WORKS
SEWER INSPECTION**

DATE: 5-9-22

Sanitary

Storm

Other

4" Size PVC

Fee \$50.00

Inspected Yes - Josh Crochiere

LOCATION OF PROPERTY: 30 Old Pasture

OWNER:

Is drain under cellar floor

Feet above cellar floor

If building has cellar or footing drains, where do they discharge:

The above fee is for the initial inspection. If initial inspection is not approved, there will be an additional fee of \$25.00 for each inspection.

It is understood that only sanitary waste is to be connected to the sanitary sewer and only clean surface or sub-surface water to storm drain.

DPW Inspector