

JOB NO.: E526

STREET ADDRESS: HSE#44 TAYLOR STREET

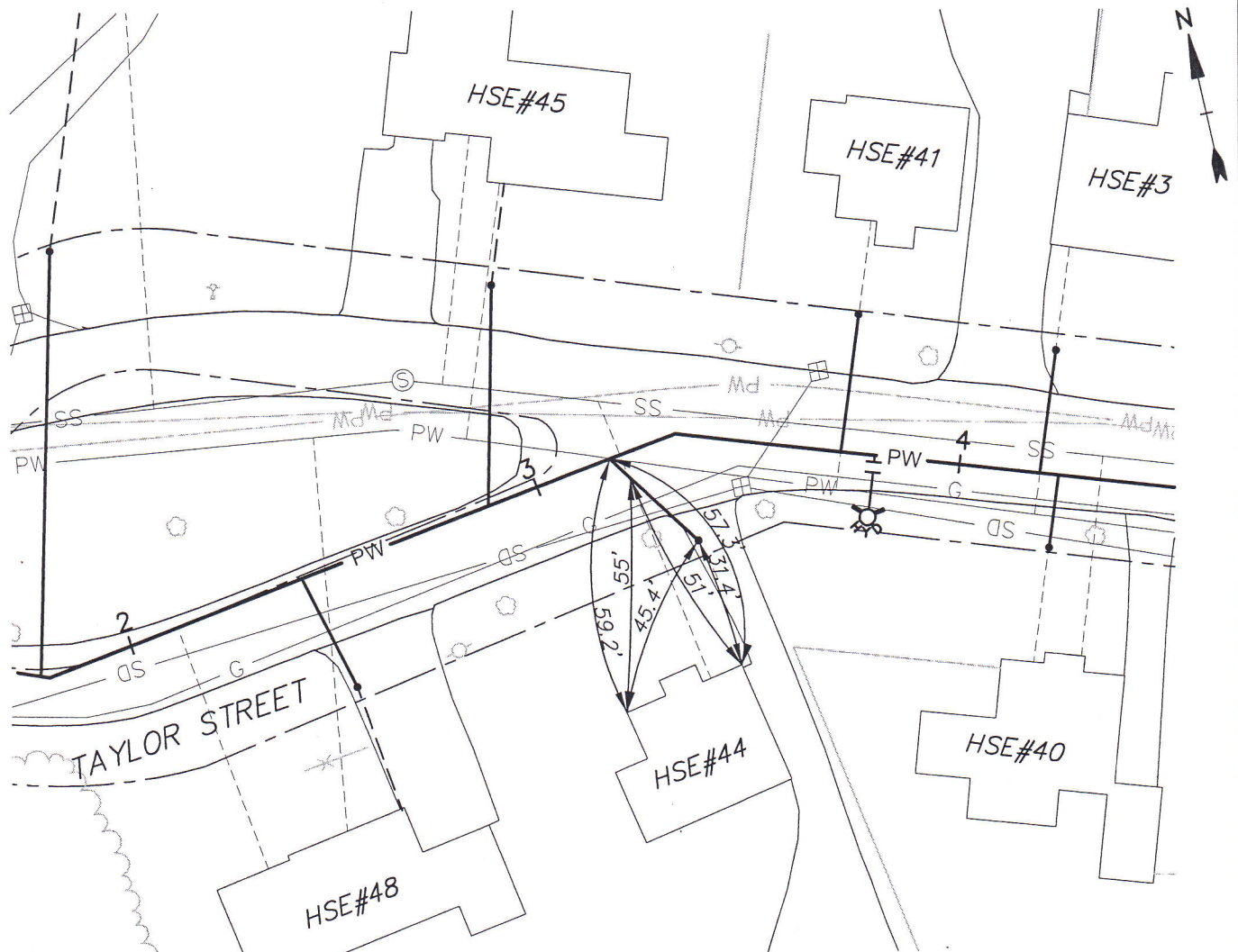

LOAM & SEED _____
BIT. DRIVEWAY _____
BIT. CURBS _____
BIT. SIDEWALK _____
CONC. CURB _____
CONC. SIDEWALK _____

SERVICE INSTALLED: 9-4-07
SIZE: 1"
MATERIAL: 1-CORP., 1-C. STOP WITH BOX
DEPTH AT MAIN: 6.0'
DEPTH AT CURB STOP: 4.5'
LENGTH OF Cu PIPE: 30.0'+.5' = 30.5'

Broke 6" vc san. sewer
Replaced with 6.5' 6" pvc
(extended prev. repair south)