

| CURRENT OWNER             |  | TOPO. | UTILITIES | STRT./ROAD | LOCATION | CURRENT ASSESSMENT |      |                 |                |
|---------------------------|--|-------|-----------|------------|----------|--------------------|------|-----------------|----------------|
| CORMIER LINDA P           |  |       | 1 TYPCL   |            |          | Description        | Code | Appraised Value | Assessed Value |
| 48 TRACEY LN              |  |       |           |            |          | RESIDENTL.         | 101  | 227,600         | 227,600        |
| EAST LONGMEADOW, MA 01028 |  |       |           |            |          | RES LAND           | 101  | 112,500         | 112,500        |
| Additional Owners:        |  |       |           |            |          | RESIDENTL.         | 101  | 4,200           | 4,200          |
| <b>SUPPLEMENTAL DATA</b>  |  |       |           |            |          |                    |      |                 |                |
| Other ID:                 |  |       |           | Received   |          |                    |      |                 |                |
| SP Permit                 |  |       |           | Field 7    |          |                    |      |                 |                |
| Chapter Land              |  |       |           | Field 8    |          |                    |      |                 |                |
| OC Dates                  |  |       |           | Field 9    |          |                    |      |                 |                |
| In+Ex FY                  |  |       |           | Field 10   |          |                    |      |                 |                |
| Mailed                    |  |       |           | ASSOC PID# |          |                    |      |                 |                |
| GIS ID: F_382187_2846094  |  |       |           |            |          |                    |      |                 |                |
| Total                     |  |       |           |            |          |                    |      | 344,300         | 344,300        |

**VISION**

1006  
AST LONGMEADOW, MA

| RECORD OF OWNERSHIP |  | BK-VOL/PAGE | SALE DATE  | q/u | v/i | SALE PRICE | V.C. | PREVIOUS ASSESSMENTS (HISTORY) |      |                |        |      |                |         |      |                |        |  |  |         |  |  |
|---------------------|--|-------------|------------|-----|-----|------------|------|--------------------------------|------|----------------|--------|------|----------------|---------|------|----------------|--------|--|--|---------|--|--|
| CORMIER LINDA P     |  | 11889/ 583  | 09/28/2001 | U   | I   | 233,000    |      | Yr.                            | Code | Assessed Value | Yr.    | Code | Assessed Value | Yr.     | Code | Assessed Value |        |  |  |         |  |  |
| KRAUS ROBERT J +,   |  | 11263/ 78   | 07/11/2000 | U   | I   | 1          | A    | 2016                           | 101  | 225,300        | 2015   | 101  | 225,300        | 2014    | B    | 214,500        |        |  |  |         |  |  |
| KRAUS ROBERT J +,   |  | 08452/ 0411 | 06/14/1993 | U   | I   | 210,000    |      | 2016                           | 101  | 109,300        | 2015   | 101  | 109,300        | 2014    | L    | 112,600        |        |  |  |         |  |  |
| KENNAR GEORGE A     |  | 05614/ 0140 | 05/18/1984 | U   | I   | 23,500     |      | 2016                           | 101  | 4,200          | 2015   | 101  | 4,200          | 2014    | O    | 5,700          |        |  |  |         |  |  |
| Total:              |  |             |            |     |     |            |      | 338,800                        |      |                | Total: |      |                | 338,800 |      |                | Total: |  |  | 332,800 |  |  |

| EXEMPTIONS |      |             |        | OTHER ASSESSMENTS |             |        |        |
|------------|------|-------------|--------|-------------------|-------------|--------|--------|
| Year       | Type | Description | Amount | Code              | Description | Number | Amount |
| Total:     |      |             |        |                   |             |        |        |

This signature acknowledges a visit by a Data Collector or Assessor

| ASSESSING NEIGHBORHOOD |           |                   |         |       |
|------------------------|-----------|-------------------|---------|-------|
| NBHD/ SUB              | NBHD Name | Street Index Name | Tracing | Batch |
| 0001/A                 |           |                   | 101     | NG    |

**APPRAISED VALUE SUMMARY**

|   |                |
|---|----------------|
| Appraised Bldg. Value (Card)            | 227,600        |
| Appraised XF (B) Value (Bldg)           | 0              |
| Appraised OB (L) Value (Bldg)           | 4,200          |
| Appraised Land Value (Bldg)             | 112,500        |
| Special Land Value                      | 0              |
| Total Appraised Parcel Value            | 344,300        |
| Valuation Method:                       | C              |
| Adjustment:                             | 0              |
| <b>Net Total Appraised Parcel Value</b> | <b>344,300</b> |

**NOTES**

94 PERMIT NVC 1/04 WOOD DECK=ALUMINUM

| BUILDING PERMIT RECORD |            |      |             |        |            |         |            | VISIT/ CHANGE HISTORY |            |      |    |     |     |                |  |
|------------------------|------------|------|-------------|--------|------------|---------|------------|-----------------------|------------|------|----|-----|-----|----------------|--|
| Permit ID              | Issue Date | Type | Description | Amount | Insp. Date | % Comp. | Date Comp. | Comments              | Date       | Type | IS | ID  | Cd. | Purpose/Result |  |
| 367                    | 11/21/2007 | 10   | SHED        | 6,766  |            | 0       |            | 12 X 30 PRE-BUILT     | 02/15/2008 |      |    | 317 | 15  | PERMIT VISIT   |  |
| 182                    | 06/20/2007 | 17   | DECK        | 15,700 |            | 0       |            | 28 X 15               | 02/15/2008 |      |    | 317 | 15  | PERMIT VISIT   |  |
| 102                    | 05/11/2004 | 11   | POOL        | 14,722 |            | 0       |            | 27' ABV GRD W/6' DEC  | 01/03/2005 |      |    | 311 | 15  | PERMIT VISIT   |  |
| 173                    | 06/01/1994 | MN   | Manual Note | 400    |            | 0       |            | WOODSTOVE             | 03/18/2004 |      |    | 250 | 22  | MAILER SENT    |  |
|                        |            |      |             |        |            |         |            |                       | 09/13/2003 |      |    | 274 | 2   | MEASURED       |  |

**LAND LINE VALUATION SECTION**

| B # | Use Code | Use Description | Zone | D | Front | Depth | Units  | Unit Price | I. Factor | S.A.   | Acre Disc | C. Factor | ST. Idx | Adj. | Notes- Adj | Special Pricing |           |  |  | S Adj Fact | Adj. Unit Price | Land Value |
|-----|----------|-----------------|------|---|-------|-------|--------|------------|-----------|--------|-----------|-----------|---------|------|------------|-----------------|-----------|--|--|------------|-----------------|------------|
|     |          |                 |      |   |       |       |        |            |           |        |           |           |         |      |            | Spec Use        | Spec Calc |  |  |            |                 |            |
| 1   | 101      | ONE FAM         | RA   |   |       |       | 39,459 | SF         | 2.23      | 1.2800 | 8         | 1.0000    | 1.00    | NG   | 1.00       |                 |           |  |  | 1.00       | 2.85            | 112,500    |

| CONSTRUCTION DETAIL |      |     |             | CONSTRUCTION DETAIL (CONTINUED) |             |            |             |
|---------------------|------|-----|-------------|---------------------------------|-------------|------------|-------------|
| Element             | Cd.  | Ch. | Description | Element                         | Cd.         | Ch.        | Description |
| Style               | 18   |     | SPLIT ENT   | #Heat Sys                       | 1           |            |             |
| Model               | 01   |     | RESIDENTIAL | Central Vac                     | 1           |            | YES         |
| Grade               | C+   |     | AVG. (+)    | FBM Sqft                        | 1073        |            |             |
| Stories             | 1.00 |     | 1 Story     | Int vs Ext                      | S           |            |             |
| Foundation          | 1    |     | CONCRETE    | <b>MIXED USE</b>                |             |            |             |
| Exterior Wall 1     | 19   |     | TEX 111     | Code                            | Description | Percentage |             |
| Exterior Wall 2     | 8    |     | BRICK VENR  | 101                             | ONE FAM     | 100        |             |
| Roof Structure      | 1    |     | GABLE       | <b>COST/MARKET VALUATION</b>    |             |            |             |
| Roof Cover          | 1    |     | ASPHALT SH  | Adj. Base Rate:                 |             |            | 96.50       |
| Interior Wall 1     | 1    |     | DRYWALL     | Replace Cost                    |             |            | 270,963     |
| Interior Wall 2     |      |     |             | AYB                             |             |            | 1984        |
| Interior Floor 1    | 3    |     | HARDWOOD    | EYB                             |             |            | 1998        |
| Interior Floor 2    | 4    |     | CARPET      | Dep Code                        |             |            | GD          |
| Heat Fuel           | 1    |     | OIL         | Remodel Rating                  |             |            |             |
| Heat Type           | 1    |     | FORCED H/A  | Year Remodeled                  |             |            |             |
| AC Type             | 03   |     | Full        | Dep %                           |             |            | 16          |
| Bedrooms            | 3    |     |             | Functional Obslnc               |             |            |             |
| Full Baths          | 3    |     |             | External Obslnc                 |             |            |             |
| Half Baths          | 0    |     |             | Cost Trend Factor               |             |            | 1           |
| Extra Fixtures      | 1    |     |             | Condition                       |             |            |             |
| Total Rooms         | 6    |     |             | % Complete                      |             |            |             |
| Bath Style          | A    |     | AVERAGE     | Overall % Cond                  |             |            | 84          |
| Kitchen Style       | A    |     | AVERAGE     | Apprais Val                     |             |            | 227,600     |
| Kitchens            | 1    |     |             | Dep % Ovr                       |             |            | 0           |
| Extra Kitchens      | 0    |     |             | Dep Ovr Comment                 |             |            |             |
| Frame               | 1    |     | WOOD        | Misc Imp Ovr                    |             |            | 0           |
| Basement Floor      | 12   |     |             | Misc Imp Ovr Comment            |             |            |             |
| Bsmt Garage         | 2    |     |             | Cost to Cure Ovr                |             |            | 0           |
| Units               | 1    |     |             | Cost to Cure Ovr Comment        |             |            |             |
| WS Flues            | 1    |     |             |                                 |             |            |             |
| FBM Quality         | 3    |     |             |                                 |             |            |             |
| Fireplaces          | 1    |     |             |                                 |             |            |             |

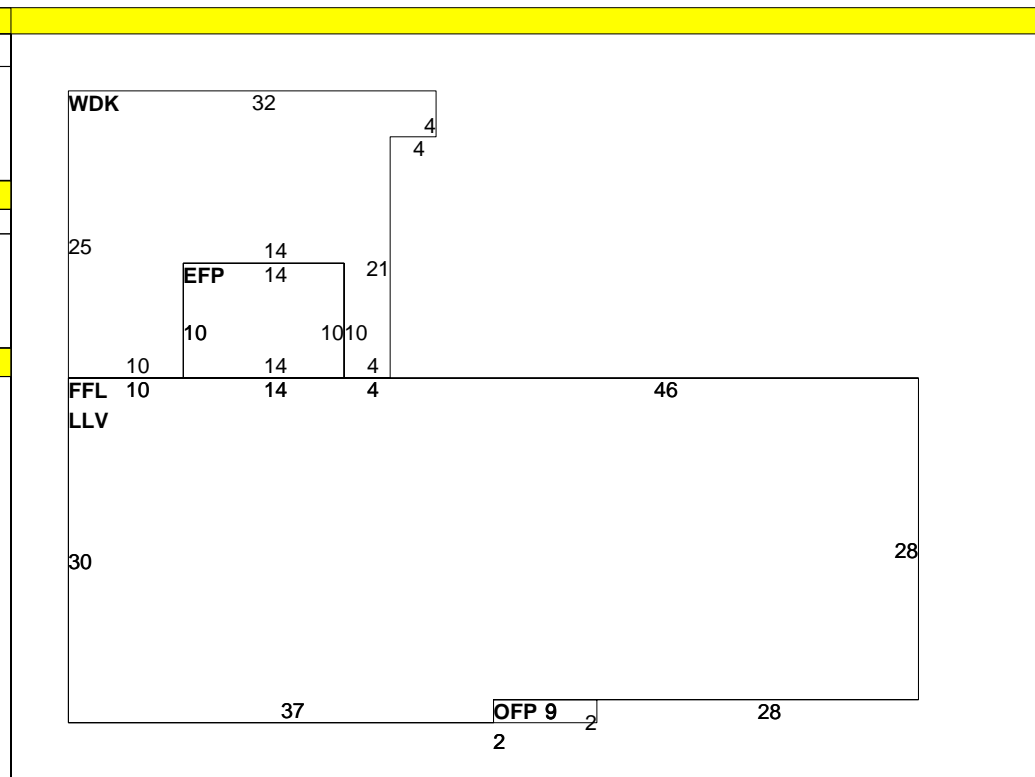

| OB-OUTBUILDING & YARD ITEMS(L) / XF-BUILDING EXTRA FEATURES(B) |             |     |              |     |       |            |      |     |       |     |      |           |
|--|-------------|-----|--------------|-----|-------|------------|------|-----|-------|-----|------|-----------|
| Code   | Description | Sub | Sub Descript | L/B | Units | Unit Price | Yr   | Gde | Dp Rt | Cnd | %Cnd | Apr Value |
| 02   | SHED/FR     |     |              | L   | 90    | 7.48       | 1998 | A   |       | GD  | 70   | 500       |
| 07   | POOL A-C    | OB  | Outbuilding  | L   | 27    | 69.00      | 2004 | A   |       | GD  | 70   | 1,300     |
| 22   | WOOD DK     |     |              | L   | 84    | 9.20       | 2004 | A   |       | GD  | 70   | 500       |
| 02   | SHED/FR     |     |              | L   | 360   | 7.48       | 2006 | A   |       | GD  | 70   | 1,900     |

| BUILDING SUB-AREA SUMMARY SECTION |             |              |              |              |           |                 |  |
|-----------------------------------|-------------|--------------|--------------|--------------|-----------|-----------------|--|
| Code                              | Description | Living Area  | Gross Area   | Eff. Area    | Unit Cost | Undeprec. Value |  |
| EFP                               | ENCL PORCH  | 0            | 140          |              | 28.95     | 4,053           |  |
| FFL                               | 1ST FLOOR   | 2,146        | 2,146        |              | 96.50     | 207,082         |  |
| LLV                               | LOWR LEVEL  | 0            | 2,146        |              | 24.15     | 51,819          |  |
| OFP                               | OPEN PORCH  | 0            | 18           |              | 10.72     | 193             |  |
| WDK                               | WOOD DECK   | 0            | 576          |              | 13.57     | 7,816           |  |
| <b>Ttl. Gross Liv/Lease Area:</b> |             | <b>2,146</b> | <b>5,026</b> | <b>2,808</b> |           | <b>270,963</b>  |  |

