

| CURRENT OWNER | | TOPO. | UTILITIES | STRT./ROAD | LOCATION | CURRENT ASSESSMENT | | | |
|---|--|--|-----------|------------|----------|--------------------|------|-----------------|----------------|
| LORTIE STEVEN C LORTIE CATHLEEN A 11 CLARESIDE DR | | | TYPCL | | | Description | Code | Appraised Value | Assessed Value |
| EAST LONGMEADOW, MA 01028 Additional Owners: | | SUPPLEMENTAL DATA Other ID: SP Permit Chapter Land OC Dates In+Ex FY Mailed GIS ID: F_391884_2847165 | | | | RESIDENTL. | 101 | 136,200 | 136,200 |
| | | | | | | RES LAND | 101 | 104,300 | 104,300 |
| | | | | | | RESIDENTL. | 101 | 10,100 | 10,100 |
| | | | | | | Total | | 250,600 | 250,600 |

1006
AST LONGMEADOW, M
VISION

| RECORD OF OWNERSHIP | | BK-VOL/PAGE | SALE DATE | q/u | v/i | SALE PRICE | V.C. | PREVIOUS ASSESSMENTS (HISTORY) | | | | | | | | |
|----------------------------------|--|---------------------------|--------------------------|-----|-----|--------------|------|--------------------------------|------|----------------|---------------|------|----------------|---------------|------|----------------|
| LORTIE STEVEN C HEARN ANNA M, | | 11448/ 600 02740/ 0136 | 12/18/2000 04/26/1960 | U | 1 | 142,600 0 | | Yr. | Code | Assessed Value | Yr. | Code | Assessed Value | Yr. | Code | Assessed Value |
| | | | | | | | | 2018 | 101 | 125,700 | 2017 | 101 | 123,400 | 2016 | 101 | 122,100 |
| | | | | | | | | 2018 | 101 | 104,300 | 2017 | 101 | 102,000 | 2016 | 101 | 98,800 |
| | | | | | | | | 2018 | 101 | 10,100 | 2017 | 101 | 10,100 | 2016 | 101 | 10,100 |
| | | | | | | | | Total: | | 240,100 | Total: | | 235,500 | Total: | | 231,000 |

| EXEMPTIONS | | | | OTHER ASSESSMENTS | | | |
|---------------|------|-------------|--------|-------------------|-------------|--------|--------|
| Year | Type | Description | Amount | Code | Description | Number | Amount |
| | | | | | | | |
| Total: | | | | | | | |

This signature acknowledges a visit by a Data Collector or Assessor

| ASSESSING NEIGHBORHOOD | | | | |
|------------------------|-----------|-------------------|---------|-------|
| NBHD/ SUB | NBHD Name | Street Index Name | Tracing | Batch |
| 0001/A | | | 101 | MG |

APPRAISED VALUE SUMMARY

| | |
|---|----------------|
| Appraised Bldg. Value (Card) | 136,200 |
| Appraised XF (B) Value (Bldg) | 0 |
| Appraised OB (L) Value (Bldg) | 10,100 |
| Appraised Land Value (Bldg) | 104,300 |
| Special Land Value | 0 |
| Total Appraised Parcel Value | 250,600 |
| Valuation Method: | C |
| Adjustment: | 0 |
| Net Total Appraised Parcel Value | 250,600 |

NOTES

| BUILDING PERMIT RECORD | | | | | | | | VISIT/ CHANGE HISTORY | | | | | | | |
|------------------------|------------|------|-------------|--------|------------|---------|------------|-----------------------|------------|------|----|-----|-----|----------------|--|
| Permit ID | Issue Date | Type | Description | Amount | Insp. Date | % Comp. | Date Comp. | Comments | Date | Type | IS | ID | Cd. | Purpose/Result | |
| 201300803 | 03/21/2013 | 12 | REROOF | 5,500 | | 0 | | | 06/07/2013 | | | 317 | 15 | PERMIT VISIT | |
| 90 | 04/25/2007 | 4 | ADDITION | 32,000 | | 0 | | 16' X 20' | 02/16/2010 | | | 316 | 15 | PERMIT VISIT | |
| 394 | 12/01/2006 | 10 | SHED | 4,000 | | 0 | | ADD TO EXISTING | 02/16/2010 | | | 316 | 14 | INSPECTED | |
| 383 | 12/14/2005 | 20 | WOOD STOVE | 2,600 | | 0 | | PELLET STOVE OC 12/ | 02/13/2009 | | | 317 | 15 | PERMIT VISIT | |
| 300 | 11/05/2001 | 10 | SHED | 3,000 | | 0 | | OC 11/13/01 | 12/28/2007 | | | 317 | 15 | PERMIT VISIT | |
| 350 | 12/21/2000 | 7 | REMODEL | 15,000 | | 0 | | KITCHEN | | | | | | | |

LAND LINE VALUATION SECTION

| B # | Use Code | Use Description | Zone | D | Front | Depth | Units | Unit Price | I. Factor | S.A. | Acre Disc | C. Factor | ST. Idx | Adj. | Notes- Adj | Special Pricing | | | S Adj Fact | Adj. Unit Price | Land Value |
|-----|----------|-----------------|------|---|-------|-------|--------|------------|-----------|--------|-----------|-----------|---------|------|------------|-----------------|-----------|--|------------|-----------------|------------|
| | | | | | | | | | | | | | | | | Spec Use | Spec Calc | | | | |
| 1 | 101 | ONE FAM | RA | | | | 25,000 | SF | 3.50 | 1.1900 | 7 | 1.0000 | 1.00 | MG | 1.00 | | | | 1.00 | 4.17 | 104,300 |

| CONSTRUCTION DETAIL | | | | CONSTRUCTION DETAIL (CONTINUED) | | | |
|---------------------|------|-----|---------------|---------------------------------|--------------------|-----|-------------------|
| Element | Cd. | Ch. | Description | Element | Cd. | Ch. | Description |
| Style | 05 | | CAPE | #Heat Sys | 1 | | |
| Model | 01 | | RESIDENTIAL | Central Vac | 0 | | NO |
| Grade | C | | AVERAGE | FBM Sqft | | | |
| Stories | 1.75 | | 1 3/4 STORIES | Int vs Ext | S | | SAME |
| Foundation | 1 | | CONCRETE | MIXED USE | | | |
| Exterior Wall 1 | 1 | | WOOD SHING | <i>Code</i> | <i>Description</i> | | <i>Percentage</i> |
| Exterior Wall 2 | | | | 101 | ONE FAM | | 100 |
| Roof Structure | 1 | | GABLE | COST/MARKET VALUATION | | | |
| Roof Cover | 1 | | ASPHALT SH | Adj. Base Rate: | | | 96.53 |
| Interior Wall 1 | 1 | | DRYWALL | Replace Cost | | | 216,228 |
| Interior Wall 2 | | | | AYB | | | 1960 |
| Interior Floor 1 | 3 | | HARDWOOD | EYB | | | 1981 |
| Interior Floor 2 | 4 | | CARPET | Dep Code | | | AG |
| Heat Fuel | 2 | | GAS | Remodel Rating | | | |
| Heat Type | 1 | | FORCED H/A | Year Remodeled | | | |
| AC Type | 01 | | NONE | Dep % | | | 37 |
| Bedrooms | 3 | | | Functional Obslnc | | | |
| Full Baths | 2 | | | External Obslnc | | | |
| Half Baths | 0 | | | Cost Trend Factor | | | 1 |
| Extra Fixtures | 0 | | | Condition | | | |
| Total Rooms | 6 | | | % Complete | | | |
| Bath Style | A | | AVERAGE | Overall % Cond | | | 63 |
| Kitchen Style | G | | GOOD | Apprais Val | | | 136,200 |
| Kitchens | 1 | | | Dep % Ovr | | | 0 |
| Extra Kitchens | 0 | | | Dep Ovr Comment | | | |
| Frame | 1 | | WOOD | Misc Imp Ovr | | | 0 |
| Basement Floor | 12 | | CONCRETE | Misc Imp Ovr Comment | | | |
| Bsmt Garage | | | | Cost to Cure Ovr | | | 0 |
| Units | 1 | | | Cost to Cure Ovr Comment | | | |
| WS Flues | | | | | | | |
| FBM Quality | | | | | | | |
| Fireplaces | 1 | | | | | | |

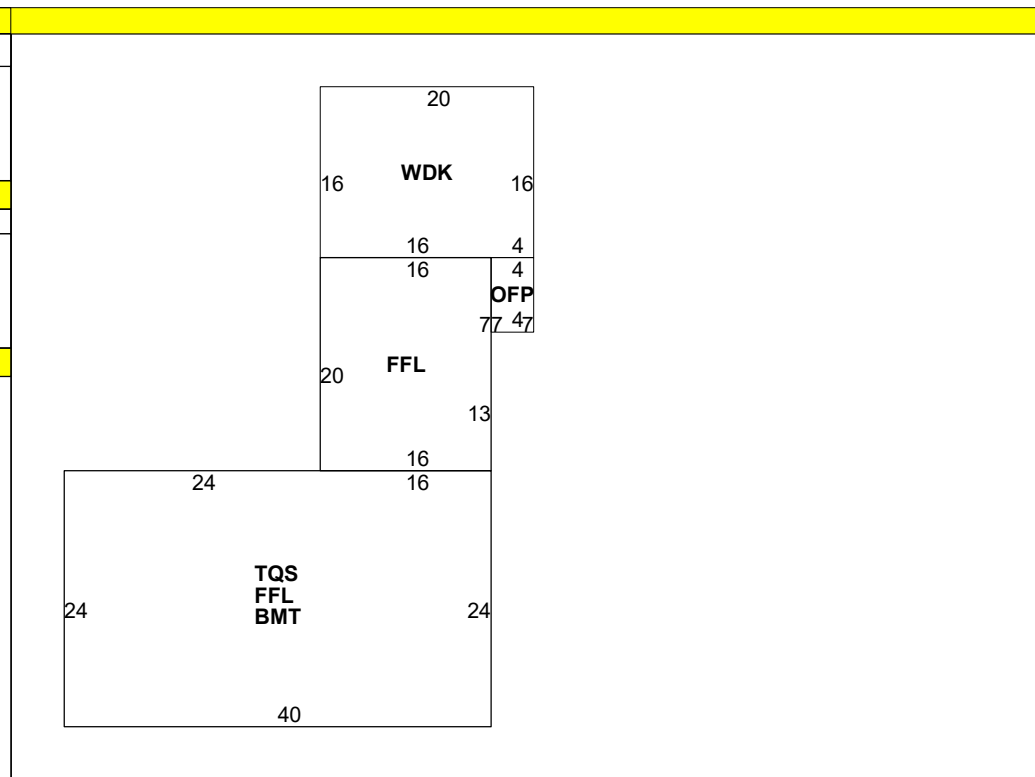

| OB-OUTBUILDING & YARD ITEMS(L) / XF-BUILDING EXTRA FEATURES(B) | | | | | | | | | | | | |
|--|-------------|-----|--------------|-----|-------|------------|------|-----|-------|-----|------|-----------|
| Code | Description | Sub | Sub Descript | L/B | Units | Unit Price | Yr | Gde | Dp Rt | Cnd | %Cnd | Apr Value |
| 03 | GARAGE | OB | Outbuilding | L | 288 | 28.18 | 1960 | A | | AV | 60 | 4,900 |
| 07 | POOL A-C | OB | Outbuilding | L | 24 | 69.00 | 2001 | A | | GD | 70 | 1,200 |
| 02 | SHED/FR | | | L | 400 | 7.48 | 2001 | G | | GD | 70 | 2,600 |
| 22 | WOOD DK | | | L | 176 | 9.20 | 2004 | G | | GD | 70 | 1,400 |

BUILDING SUB-AREA SUMMARY SECTION

| Code | Description | Living Area | Gross Area | Eff. Area | Unit Cost | Undeprec. Value |
|-----------------------------------|-------------|--------------|--------------|--------------|-----------|-----------------|
| BMT | BASEMENT | 0 | 960 | | 19.31 | 18,534 |
| FFL | 1ST FLOOR | 1,280 | 1,280 | | 96.53 | 123,559 |
| OFP | OPEN PORCH | 0 | 28 | | 10.34 | 290 |
| TQS | 3/4 STORY | 720 | 960 | | 72.40 | 69,502 |
| WDK | WOOD DECK | 0 | 320 | | 13.57 | 4,344 |
| Ttl. Gross Liv/Lease Area: | | 2,000 | 3,548 | 2,240 | | 216,228 |

