

CURRENT OWNER		TOPO TYPE	UTILITY	STREET	LOCATION	CURRENT ASSESSMENT				
KRUZELOF MAGDALENA NOGUEIRA DANIEL 22 YOUNG AV EAST LONGMEADOW MA 01028						Description	Code	Appraised	Assessed	1006 EAST LONGMEADOW
		TOPO WET	EASEMENT	TRAFFIC	CORNER	RESIDNTL.	101	178700	178,700	
		DRAINAGE		VIEW	COMMUNITY	RES LAND	101	75000	75,000	
		SUPPLEMENTAL DATA				Total		253,700	253,700	
GIS ID F_376032_2853370		Alt Prcl ID SP Permit Chapter Land OC Dates 1/9/2013 In+Ex FY Mailed		Received NIA Field 8 Field 9 Field 10 Assoc Pid#						

RECORD OF OWNERSHIP		BK-VOL/PAGE	SALE DATE	Q/U	V/I	SALE PRICE	VC	PREVIOUS ASSESSMENTS (HISTORY)								
KRUZELOF MAGDALENA		22399 0477	10-12-2018	Q	I	247,000	00	Year	Code	Assessed	Year	Code	Assessed	Year	Code	Assessed
CARABINE DAVID P		19646 0189	01-18-2013	Q	I	216,500	00	2019	101	173,900	2018	101	161,100	2017	101	154,600
NU WAY HOMES INC,		19039 0428	12-15-2011	U	I	80,000	1V		101	72,900		101	72,900		101	71,200
GEROW JENNIE J,		08871 0016	06-27-1994	U	I	1	1A									
GEROW NORA E		01820 0302	04-08-1946	U	I	0										
Total								246800		Total		234000		Total		225800

EXEMPTIONS				OTHER ASSESSMENTS				This signature acknowledges a visit by a Data Collector or Assessor												
Year	Code	Description	Amount	Code	Description	YEAR	Amount	Comm Int												
Total			0.00																	

ASSESSING NEIGHBORHOOD				
Nbhd	Nbhd Name	B	Tracing	Batch
0001			101	MA

NOTES															

BUILDING PERMIT RECORD										VISIT / CHANGE HISTORY					
Permit Id	Issue Date	Type	Description	Amount	Insp Date	% Comp	Date Comp	Comments	Date	Type	Is	Id	Cd	Purpose/Result	
201103046 20	01-18-2012 01-01-1982	2 MN	DWELLING Manual Note	144,500				OC 1/9/2013 INCL WOOD STOVE	01-09-2013 06-22-2012 06-08-2012 04-27-2012 11-18-2011 05-10-2004 04-07-2004			400 317 317 317 317 318 250	25 15 15 15 24 14 22	OC VISIT PERMIT VISIT PERMIT VISIT PERMIT VISIT ABATEMENT VI INSPECTED MAILER SENT	

LAND LINE VALUATION SECTION																					
B	Use Co	Description	Zone	D	Fronta	Depth	Land Units	Unit Price	I. Fact	S.A.	Ac Di	C. Fact	St. Idx	Adj	Notes	Special Pricing			Size A	Adj Unit Pric	Land Value
1	101	ONE FAM	RC				6,140 SF	13.58	1.000	5	LAND	0.90	MA	1.00	CLOC		0		1.000	12.22	75,000
Total Card Land Units							0.141	AC	Parcel Total Land Area:			0.1410	Total Land Value							75,000	

CONSTRUCTION DETAIL			CONSTRUCTION DETAIL (CONTINUED)		
Element	Cd	Description	Element	Cd	Description
Style	06	COLONIAL	Basement Floor	12	CONCRETE
Model	01	RESIDENTIAL	Bsmt Garage		
Grade	C	AVERAGE	#Heat Sys	1.00	
Stories	2.00	2 STORY	Units	1	
Foundation	1	CONCRETE	MIXED USE		
Exterior Wall 1	4	VINYL	Code	Description	Percentage
Exterior Wall 2			101	ONE FAM	100
Roof Structure	1	GABLE			0
Roof Cover	1	ASPHALT SH			0
Interior Wall 1	1	DRYWALL	COST / MARKET VALUATION		
Interior Wall 2			Adj Base Rate		98.68
Interior Floor 1	3	HARDWOOD	RCN		184,253
Interior Floor 2	4	CARPET	Net Other Adj		
Heat Fuel	2	GAS	Year Built		2012
Heat Type	1	FORCED H/A	Effective Year Built		2015
AC Type	03	FULL	Depreciation Code		GD
Bedrooms	3		Remodel Rating		
Full Baths	1		Year Remodeled		
Half Baths	1		Depreciation %		3
Extra Fixtures	1		Functional Obsol		
Total Rooms	6		External Obsol		
Bath Style	A	AVERAGE	Cost Trend Factor		1
Half Bath Style	A	AVERAGE	Condition		
Kitchens	1		% Complete		
Kitchen Style	G	GOOD	Overall % Condition		97
Extra Kitchens	0		RCNLD		178,700
Extra Kitchen St			Dep % Ovr		
FBM Sqft			Dep Ovr Comment		
FBM Quality			Misc Imp Ovr		
Fireplaces	1		Misc Imp Ovr Comment		
WS Flues			Cost to Cure Ovr		
Central Vac	0	NO	Cost to Cure Ovr Comment		
Frame	1	WOOD			

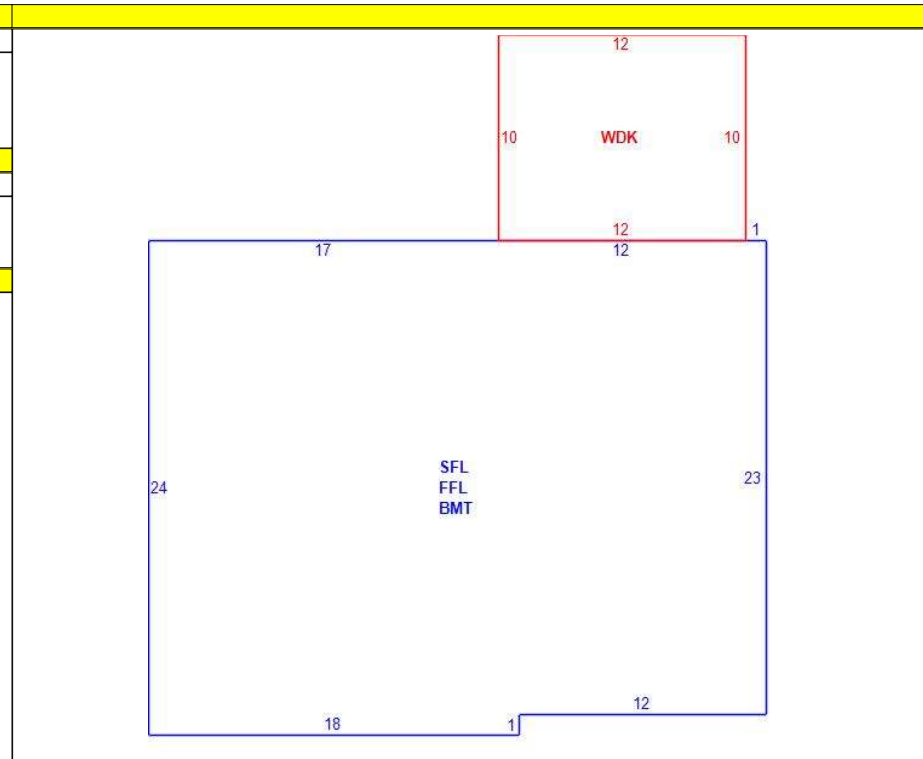

OB - OUTBUILDING & YARD ITEMS(L) / XF - BUILDING EXTRA FEATURES(B)													
Code	Description	Su	Sub Type	Lan	Units	Unit Price	Yr Blt	%	Dep.	Cond	Gra	Qual	Apprais Va

BUILDING SUB-AREA SUMMARY SECTION							
Subarea	Description	Living	Gross	Eff Area	Unit Cost	Undeprec Value	
BMT	BASEMENT	0	708		23.46	16,612	
FFL	1ST FLOOR	708	708		116.99	82,826	
SFL	2ND FLOOR	708	708		116.99	82,826	
WDK	WOOD DECK	0	120		16.57	1,989	
Ttl Gross Liv / Lease Area		1,416	2,244	1,575		184,253	

