

CURRENT OWNER		TOPO TYPE	UTILITY	STREET	LOCATION	CURRENT ASSESSMENT				
SAYDLOWSKI PAUL J SAYDLOWSKI MARIE E 23 GREENWICH RD EAST LONGMEADOW MA 01028						Description	Code	Appraised	Assessed	1006 EAST LONGMEADOW
		TOPO WET	EASEMENT	TRAFFIC	CORNER	RESIDNTL.	101	204100	204,100	
		DRAINAGE		VIEW	COMMUNITY	RES LAND	101	126000	126,000	
						RESIDNTL.	101	2100	2,100	
SUPPLEMENTAL DATA										
Alt Prcl ID SP Permit Chapter Land OC Dates In+Ex FY Mailed				Received NIA Field 8 Field 9 Field 10 Assoc Pid#						
Total							332,200		332,200	

RECORD OF OWNERSHIP		BK-VOL/PAGE	SALE DATE	Q/U	V/I	SALE PRICE	VC	PREVIOUS ASSESSMENTS (HISTORY)								
SAYDLOWSKI PAUL J		08964	0147	10-07-1994	U	I	165,000	Year	Code	Assessed	Year	Code	Assessed	Year	Code	Assessed
AYERS DONALD H HEIRS +		02942	0261	04-02-1963	U	I	0	2019	101	198,100	2018	101	173,000	2017	101	178,700
									101	122,500		101	122,500		101	132,000
									101	2,100		101	2,100		101	2,100
Total							322700		Total		297600		Total		312800	

EXEMPTIONS				OTHER ASSESSMENTS				This signature acknowledges a visit by a Data Collector or Assessor				
Year	Code	Description	Amount	Code	Description	YEAR	Amount	Comm Int				
Total			0.00									

ASSESSING NEIGHBORHOOD				
Nbhd	Nbhd Name	B	Tracing	Batch
0001			101	NV

NOTES			

BUILDING PERMIT RECORD										VISIT / CHANGE HISTORY					
Permit Id	Issue Date	Type	Description	Amount	Insp Date	% Comp	Date Comp	Comments	Date	Type	Is	Id	Cd	Purpose/Result	
254	10-07-2003	4	ADDITION	38,500					05-18-2018			333	2	MEASURED	
									03-15-2005			311	14	INSPECTED	
									01-11-2005			311	2	MEASURED	
									02-06-2004			311	15	PERMIT VISIT	
									04-08-2002			105	3	MEAS+INSPCTD	
									03-22-2002			250	22	MAILER SENT	
									11-13-2001			247	2	MEASURED	

LAND LINE VALUATION SECTION																					
B	Use Co	Description	Zone	D	Fronta	Depth	Land Units	Unit Price	I. Fact	S.A.	Ac Di	C. Fact	St. Idx	Adj	Notes	Special Pricing			Size A	Adj Unit Pric	Land Value
1	101	ONE FAM	RA				25,000 SF	3.60	1.400	9	LAND	1.00	NV	1.00			0		1.000	5.04	126,000
Total Card Land Units							0.574	AC	Parcel Total Land Area:			0.5739								Total Land Value	126,000

CONSTRUCTION DETAIL			CONSTRUCTION DETAIL (CONTINUED)		
Element	Cd	Description	Element	Cd	Description
Style	06	COLONIAL	Basement Floor	12	CONCRETE
Model	01	RESIDENTIAL	Bsmt Garage		
Grade	C+	AVG. (+)	#Heat Sys	1.00	
Stories	2.00	2 STORY	Units	1	
Foundation	1	CONCRETE	MIXED USE		
Exterior Wall 1	2	CLAPBOARD	Code	Description	Percentage
Exterior Wall 2			101	ONE FAM	100
Roof Structure	3	GAMBREL			0
Roof Cover	1	ASPHALT SH			0
Interior Wall 1	1	DRYWALL	COST / MARKET VALUATION		
Interior Wall 2			Adj Base Rate		68.62
Interior Floor 1	3	HARDWOOD	RCN		323,933
Interior Floor 2			Net Other Adj		
Heat Fuel	2	GAS	Year Built		1966
Heat Type	1	FORCED H/A	Effective Year Built		1981
AC Type	01	NONE	Depreciation Code		AG
Bedrooms	3		Remodel Rating		
Full Baths	1		Year Remodeled		
Half Baths	1		Depreciation %		37
Extra Fixtures	0		Functional Obsol		
Total Rooms	7		External Obsol		
Bath Style	A	AVERAGE	Cost Trend Factor		1
Half Bath Style	A	AVERAGE	Condition		
Kitchens	1		% Complete		
Kitchen Style	A	AVERAGE	Overall % Condition		63
Extra Kitchens	0		RCNLD		204,100
Extra Kitchen St			Dep % Ovr		
FBM Sqft			Dep Ovr Comment		
FBM Quality			Misc Imp Ovr		
Fireplaces	2		Misc Imp Ovr Comment		
WS Flues			Cost to Cure Ovr		
Central Vac	0	NO	Cost to Cure Ovr Comment		
Frame	1	WOOD			

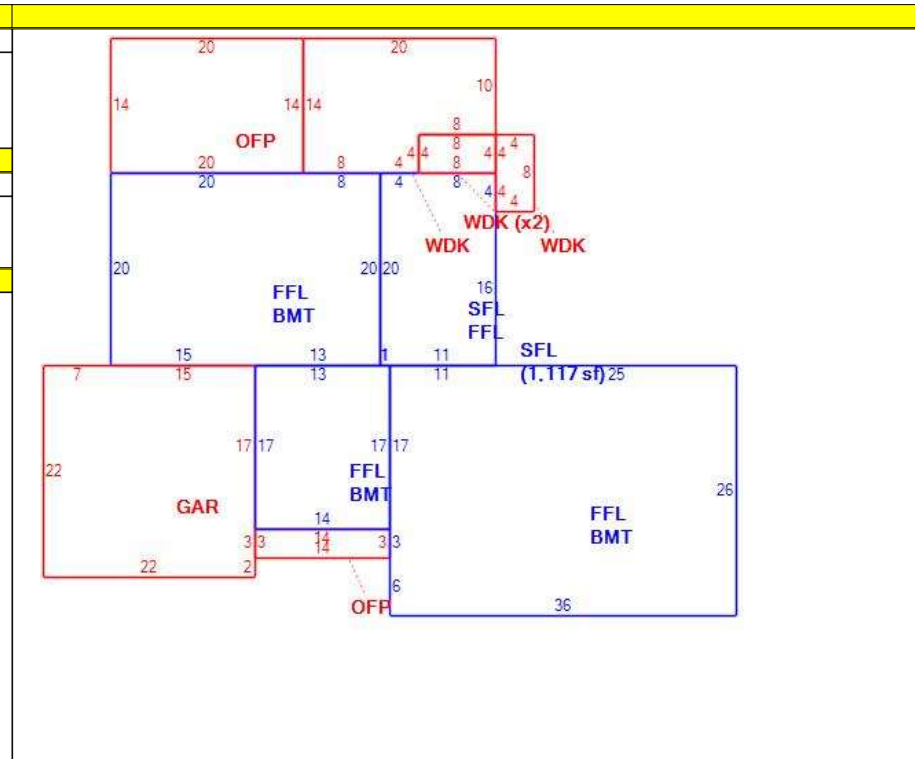

OB - OUTBUILDING & YARD ITEMS(L) / XF - BUILDING EXTRA FEATURES(B)													
Code	Description	Su	Sub Type	Lan	Units	Unit Price	Yr Blt	%	Dep.	Cond	Gra	Qual	Apprais Va
02	SHED/FR			L	48	7.48	1970	60	0.00	AV	A	1.00	200
19	PATIO			L	480	5.75	1990	70	0.00	GD	A	1.00	1,900

BUILDING SUB-AREA SUMMARY SECTION							
Subarea	Description	Living	Gross	Eff Area	Unit Cost	Undeprec Value	
BMT	BASEMENT	0	1,734		16.40	28,443	
FFL	1ST FLOOR	1,974	1,974		81.97	161,803	
GAR	GARAGE	0	484		32.85	15,902	
OFF	OPEN PORCH	0	322		8.15	2,623	
SFL	2ND FLOOR	1,357	1,357		81.97	111,229	
WDK	WOOD DECK	0	344		11.44	3,934	
Ttl Gross Liv / Lease Area		3,331	6,215	3,952		323,933	

