

CURRENT OWNER		TOPO TYPE	UTILITY	STREET	LOCATION	CURRENT ASSESSMENT				
BONNER AARON B + ALISON D						Description	Code	Appraised	Assessed	1006 EAST LONGMEADOW
281 SOMERS RD		TOPO WET	EASEMENT	TRAFFIC	CORNER	RESIDNTL.	101	305400	305,400	
EAST LONGMEADOW MA 01028		DRAINAGE		VIEW	COMMUNITY	RES LAND	101	81000	81,000	
GIS ID F_385491_2846490		SUPPLEMENTAL DATA				Total		386,400	386,400	
Alt Prcl ID SP Permit Chapter Land OC Dates 11/4/2014 In+Ex FY Mailed		Received NIA Field 8 Field 9 Field 10 Assoc Pid#								

RECORD OF OWNERSHIP		BK-VOL/PAGE	SALE DATE	Q/U	V/I	SALE PRICE	VC	PREVIOUS ASSESSMENTS (HISTORY)									
BONNER AARON B + ALISON D		20502	0513	11-17-2014	Q	I	353,900	00	Year	Code	Assessed	Year	Code	Assessed	Year	Code	Assessed
BEDROCK FINANCIAL LLC TRUSTEE		18715	0224	03-24-2011	U	V	285,000	1V	2019	101	297,400	2018	101	266,500	2017	101	252,900
GOLDSTEIN MARIE L ESTATE OF,		0000	0000		U		0			101	78,800		101	78,800		101	77,000
Total									Total		376200	Total		345300	Total		329900

EXEMPTIONS				OTHER ASSESSMENTS				This signature acknowledges a visit by a Data Collector or Assessor										
Year	Code	Description	Amount	Code	Description	YEAR	Amount	Comm Int										
Total			0.00															

ASSESSING NEIGHBORHOOD				APPRAISED VALUE SUMMARY					
Nbhd	Nbhd Name	B		Tracing	Batch				
0001				101	MA				

NOTES															
FY13 SUB DIV 1092-NEW LOT 8-BK PLANS 362-74(25243 SF FROM PARCEL 40-35-0).															

BUILDING PERMIT RECORD								VISIT / CHANGE HISTORY							
Permit Id	Issue Date	Type	Description	Amount	Insp Date	% Comp	Date Comp	Comments	Date	Type	Is	Id	Cd	Purpose/Result	
201800885	03-14-2018	7	REMODEL	3,500	07-03-2018	100		FIN BMT ADD HALF	07-03-2018			400	15	PERMIT VISIT	
201302961	11-15-2013	2	DWELLING	190,000	05-02-2014	100	10-30-2014	OC 11/4/2014 INCL	10-30-2014	01		400	25	OC VISIT	
									05-02-2014			317	2	MEASURED	

LAND LINE VALUATION SECTION																					
B	Use Co	Description	Zone	D	Fronta	Depth	Land Units	Unit Price	I. Fact	S.A.	Ac Di	C. Fact	St. Idx	Adj	Notes	Special Pricing			Size A	Adj Unit Pric	Land Value
1	101	ONE FAM	RA				25,243 SF	3.57	1.000	5	LAND	1.00	MA	1.00		0	TRF2	0.9	1.000	3.21	81,000
Total Card Land Units							0.579	AC	Parcel Total Land Area:			0.5795	Total Land Value							81,000	

CONSTRUCTION DETAIL			CONSTRUCTION DETAIL (CONTINUED)		
Element	Cd	Description	Element	Cd	Description
Style	06	COLONIAL	Basement Floor	12	CONCRETE
Model	01	RESIDENTIAL	Bsmt Garage		
Grade	B-	GOOD (-)	#Heat Sys	1.00	
Stories	2		Units	1	
Foundation	1	CONCRETE	MIXED USE		
Exterior Wall 1	4	VINYL	Code	Description	Percentage
Exterior Wall 2			101	ONE FAM	100
Roof Structure	1	GABLE			0
Roof Cover	1	ASPHALT SH			0
Interior Wall 1	1	DRYWALL	COST / MARKET VALUATION		
Interior Wall 2			Adj Base Rate		82.97
Interior Floor 1	3	HARDWOOD	RCN		314,816
Interior Floor 2	4	CARPET	Net Other Adj		
Heat Fuel	2	GAS	Year Built		2013
Heat Type	1	FORCED H/A	Effective Year Built		2015
AC Type	03	FULL	Depreciation Code		GD
Bedrooms	4		Remodel Rating		
Full Baths	2		Year Remodeled		
Half Baths	2		Depreciation %		3
Extra Fixtures	1		Functional Obsol		
Total Rooms	7		External Obsol		
Bath Style	G	GOOD	Cost Trend Factor		1
Half Bath Style	G	GOOD	Condition		
Kitchens	1		% Complete		
Kitchen Style	G	GOOD	Overall % Condition		97
Extra Kitchens			RCNLD		305,400
Extra Kitchen St			Dep % Ovr		
FBM Sqft	560		Dep Ovr Comment		
FBM Quality	3		Misc Imp Ovr		
Fireplaces	1		Misc Imp Ovr Comment		
WS Flues			Cost to Cure Ovr		
Central Vac			Cost to Cure Ovr Comment		
Frame	1	WOOD			

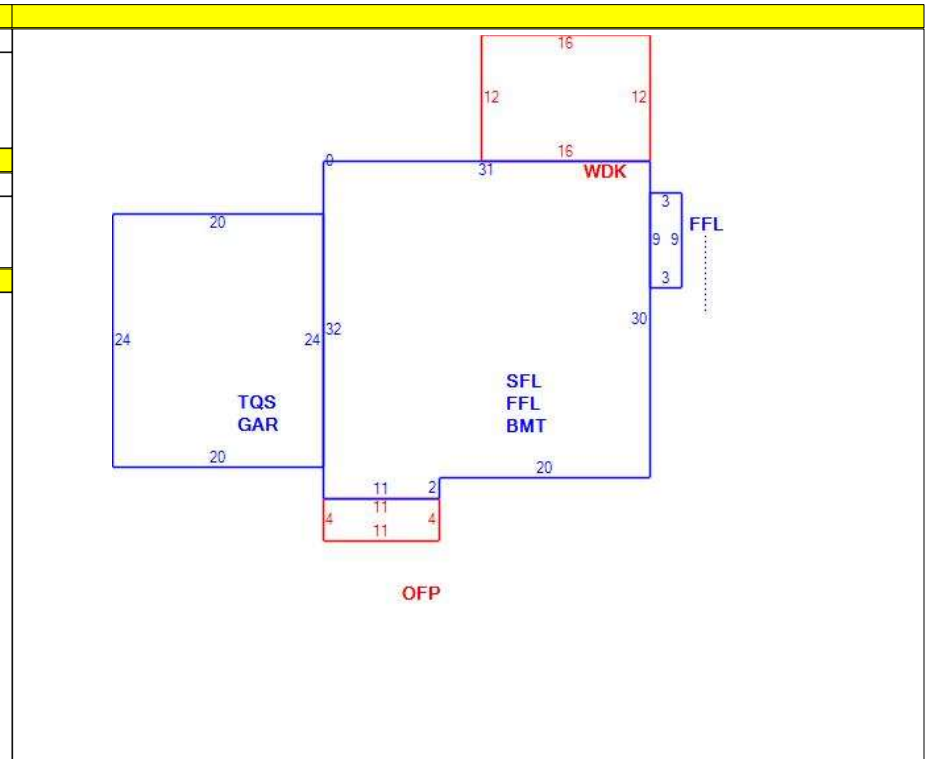

OB - OUTBUILDING & YARD ITEMS(L) / XF - BUILDING EXTRA FEATURES(B)													
Code	Description	Su	Sub Type	Lan	Units	Unit Price	Yr Blt	%	Dep.	Cond	Gra	Qual	Apprais Va

BUILDING SUB-AREA SUMMARY SECTION							
Subarea	Description	Living	Gross	Eff Area	Unit Cost	Undeprec Value	
BMT	BASEMENT	0	952		23.24	22,121	
FFL	1ST FLOOR	979	979		116.43	113,981	
GAR	GARAGE	0	480		46.57	22,354	
OFF	OPEN PORCH	0	44		10.58	466	
SFL	2ND FLOOR	952	952		116.43	110,838	
TQS	3/4 STORY	360	480		87.32	41,913	
WDK	WOOD DECK	0	192		16.37	3,144	
Ttl Gross Liv / Lease Area		2,291	4,079	2,704		314,816	

