

CURRENT OWNER		TOPO TYPE	UTILITY	STREET	LOCATION	CURRENT ASSESSMENT				
BISHOP LYNDA M 151 SMITH AV EAST LONGMEADOW MA 01028						Description	Code	Appraised	Assessed	1006 EAST LONGMEADOW
		TOPO WET	EASEMENT	TRAFFIC	CORNER	RESIDNTL.	101	188800	188,800	
						RES LAND	101	101600	101,600	
		DRAINAGE		VIEW	COMMUNITY	RESIDNTL.	101	400	400	
SUPPLEMENTAL DATA										
Alt Prcl ID SP Permit Chapter Land OC Dates In+Ex FY Mailed				Received NIA Field 8 Field 9 Field 10 Assoc Pid#		Total		290,800	290,800	

RECORD OF OWNERSHIP		BK-VOL/PAGE	SALE DATE	Q/U	V/I	SALE PRICE	VC	PREVIOUS ASSESSMENTS (HISTORY)								
BISHOP LYNDA M	23237	0094	06-01-2020	Q	I	260,000	00	Year	Code	Assessed	Year	Code	Assessed	Year	Code	Assessed
FYDENKEVEZ PAUL J	17595	0538	12-30-2008	U	I	228,500		2022	101	170,300	2021	101	163,400	2020	101	147,200
MCDONALD,MAUREEN M	00000	0000	01-19-2001	U	I	1	1		101	92,400		101	85,600		101	85,600
MCDONOUGH,EDWARD T	06882	0172	06-28-1988	U	I	0	1F		101	400		101	400		101	400
GIUGGIO	05652	0093	07-17-1984	U	I	62,900	1	Total		263,100	Total		249,400	Total		233,200

EXEMPTIONS				OTHER ASSESSMENTS				This signature acknowledges a visit by a Data Collector or Assessor										
Year	Code	Description	Amount	Code	Description	YEAR	Amount	Comm Int										
Total			0.00															

ASSESSING NEIGHBORHOOD			
Nbhd	Nbhd Name	Tracing	Batch
0001		101	MA

NOTES															

BUILDING PERMIT RECORD								VISIT / CHANGE HISTORY							
Permit Id	Issue Date	Type	Description	Amount	Insp Date	% Comp	Date Comp	Comments	Date	Type	Is	Id	Cd	Purpose/Result	
201701721	06-16-2017	21	SIDING	10,015	05-10-2018	100	05-10-2018	2NDFL COMP DWELLING	05-10-2018			333	3	MEAS+INSPCTD	
235	09-29-2009	54	FENCE	3,900		0			12-15-2005			311	3	MEAS+INSPCTD	
303	01-01-1985	MN	Manual Note						04-02-2004			317	2	MEASURED	
72	01-01-1984	MN	Manual Note						09-04-1990			131	11	ENTRY DENIED	
									02-14-1985			500	15	PERMIT VISIT	

LAND LINE VALUATION SECTION																					
B	Use Co	Description	Zone	D	Fronta	Depth	Land Units	Unit Price	I. Fact	S.A.	Ac Di	C. Fact	St. Idx	Adj	Notes	Special Pricing			Size A	Adj Unit Pric	Land Value
1	101	ONE FAM	RC				12,000 SF	8.47	1.000	5	LAND	1.00	MA	1.00		0			1.000	8.47	101,600
Total Card Land Units							0.28	AC	Parcel Total Land Area:				0.28	Total Land Value							101,600

CONSTRUCTION DETAIL			CONSTRUCTION DETAIL (CONTINUED)		
Element	Cd	Description	Element	Cd	Description
Style	05	CAPE	Basement Floor	12	CONCRETE
Model	01	RESIDENTIAL	Bsmt Garage		
Grade	C	AVERAGE	#Heat Sys	1.00	
Stories	1.75	1 3/4 STORIES	Units	1	
Foundation	1	CONCRETE	MIXED USE		
Exterior Wall 1	4	VINYL	Code	Description	Percentage
Exterior Wall 2			101	ONE FAM	100
Roof Structure	1	GABLE			0
Roof Cover	1	ASPHALT SH			0
Interior Wall 1	1	DRYWALL	COST / MARKET VALUATION		
Interior Wall 2			Adj Base Rate		119.87
Interior Floor 1	4	CARPET	RCN		239,030
Interior Floor 2	3	HARDWOOD	Net Other Adj		
Heat Fuel	2	GAS	Year Built		1984
Heat Type	1	FORCED H/A	Effective Year Built		2000
AC Type	03	FULL	Depreciation Code		GD
Bedrooms	3		Remodel Rating		
Full Baths	2		Year Remodeled		
Half Baths	0		Depreciation %		21
Extra Fixtures	0		Functional Obsol		
Total Rooms	6		External Obsol		
Bath Style	A	AVERAGE	Cost Trend Factor		1
Half Bath Style			Condition		
Kitchens	1		% Complete		
Kitchen Style	A	AVERAGE	Overall % Condition		79
Extra Kitchens	0		RCNLD		188,800
Extra Kitchen St			Dep % Ovr		
FBM Sqft	605		Dep Ovr Comment		
FBM Quality	3		Misc Imp Ovr		
Fireplaces	0		Misc Imp Ovr Comment		
WS Flues			Cost to Cure Ovr		
Central Vac	0	NO	Cost to Cure Ovr Comment		
Frame	1	WOOD			

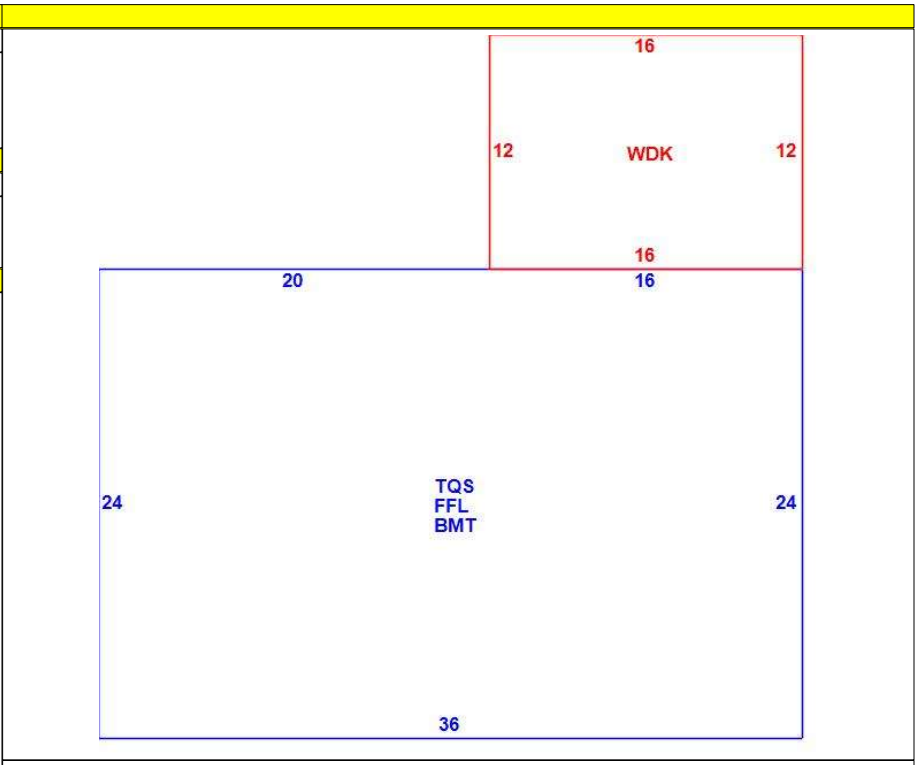

OB - OUTBUILDING & YARD ITEMS(L) / XF - BUILDING EXTRA FEATURES(B)													
Code	Description	Su	Sub Type	Lan	Units	Unit Price	Yr Blt	%	Dep.	Cond	Gra	Qual	Apprais Va
02	SHED/FR			L	96	7.48	1990	50	0.00	FR	A	1.00	400

BUILDING SUB-AREA SUMMARY SECTION							
Subarea	Description	Living	Gross	Eff Area	Unit Cost	Undeprec Value	
BMT	BASEMENT	0	864		27.78	24,000	
FFL	1ST FLOOR	864	864		138.73	119,862	
TQS	3/4 STORY	648	864		104.05	89,896	
WDK	WOOD DECK	0	192		27.46	5,272	
Ttl Gross Liv / Lease Area		1,512	2,784			239,030	

