

| CURRENT OWNER | | TOPO TYPE | UTILITY | STREET | LOCATION | CURRENT ASSESSMENT | | | | |
|---|--|-----------------|-----------------|---|------------------|--------------------|------|-----------|----------|-----------------------------|
| ROY ROBERT J ROY TAMMY L 30 SAUGUS AV EAST LONGMEADOW MA 01028 | | | | | | Description | Code | Appraised | Assessed | 1006 EAST LONGMEADOW |
| | | TOPO WET | EASEMENT | TRAFFIC | CORNER | RESIDNTL. | 101 | 306200 | 306,200 | |
| | | DRAINAGE | | VIEW | COMMUNITY | RES LAND | 101 | 111800 | 111,800 | |
| | | | | | | RESIDNTL. | 101 | 2900 | 2,900 | |
| SUPPLEMENTAL DATA | | | | | | | | | | |
| Alt Prcl ID SP Permit Chapter Land OC Dates 3/9/2012 In+Ex FY Mailed | | | | Received NIA Field 8 Field 9 Field 10 Assoc Pid# | | Total | | 420,900 | 420,900 | |

| RECORD OF OWNERSHIP | | BK-VOL/PAGE | SALE DATE | Q/U | V/I | SALE PRICE | VC | PREVIOUS ASSESSMENTS (HISTORY) | | | | | | | | |
|----------------------------|-------|-------------|------------|-----|-----|------------|----|--------------------------------|------|----------|-------|------|----------|-------|------|----------|
| ROY ROBERT J | 22241 | 0383 | 06-29-2018 | Q | I | 335,000 | 00 | Year | Code | Assessed | Year | Code | Assessed | Year | Code | Assessed |
| LECH TOM | 21773 | 0043 | 07-20-2017 | Q | I | 315,000 | 00 | 2023 | 101 | 281,400 | 2022 | 101 | 250,900 | 2021 | 101 | 240,600 |
| FREEMAN JAIMIE | 19179 | 0334 | 03-26-2012 | U | I | 293,000 | 00 | | 101 | 101,600 | | 101 | 92,400 | | 101 | 85,600 |
| TORCIA MICHAEL, | 18801 | 0184 | 06-10-2011 | U | V | 71,000 | 1 | | 101 | 1,900 | | | | | | |
| DECOTEAU RONALD P TRUSTEE, | 18437 | 0509 | 08-30-2010 | U | I | 100 | 1B | Total | | 384,900 | Total | | 343,300 | Total | | 326,200 |

| EXEMPTIONS | | | | OTHER ASSESSMENTS | | | | This signature acknowledges a visit by a Data Collector or Assessor | | | | |
|------------|------|-------------|--------|-------------------|-------------|------|--------|---|--|--|--|--|
| Year | Code | Description | Amount | Code | Description | YEAR | Amount | Comm Int | | | | |
| Total | | | | | | | | | | | | |

| ASSESSING NEIGHBORHOOD | | | | APPRAISED VALUE SUMMARY | | | | |
|------------------------|-----------|---------|-------|----------------------------------|--|--|--|---------|
| Nbhd | Nbhd Name | Tracing | Batch | Appraised BLDG. Value (Card) | | | | 306,200 |
| 0001 | | 101 | MA | Appraised Xf (B) Value (Bldg) | | | | 0 |
| | | | | Appraised Ob (B) Value (Bldg) | | | | 2,900 |
| | | | | Appraised Land Value (Bldg) | | | | 111,800 |
| | | | | Special Land Value | | | | 0 |
| | | | | Total Appraised Parcel Value | | | | 420,900 |
| | | | | Valuation Method | | | | C |
| | | | | Adjustment | | | | |
| | | | | Net Total Appraised Parcel Value | | | | 420,900 |

| BUILDING PERMIT RECORD | | | | | | | | | | VISIT / CHANGE HISTORY | | | | | |
|------------------------|------------|------|-------------|---------|-----------|--------|-----------|-------------------|------------|------------------------|----|-----|----|----------------|--|
| Permit Id | Issue Date | Type | Description | Amount | Insp Date | % Comp | Date Comp | Comments | Date | Type | Is | Id | Cd | Purpose/Result | |
| B-23-699 | 09-28-2023 | 9 | ALTERATION | 62,000 | | 0 | | WDK TO SUNROO | 11-30-2021 | | | 334 | 2 | MEASURED | |
| 222 | 08-10-2011 | 2 | DWELLING | 170,000 | | | | OC 3-9-12 1694 SF | 03-09-2012 | | | 400 | 25 | OC VISIT | |
| | | | | | | | | | 03-09-2012 | | | 317 | 2 | MEASURED | |
| | | | | | | | | | 06-27-1980 | | | 500 | 14 | INSPECTED | |

| LAND LINE VALUATION SECTION | | | | | | | | | | | | | | | | | | | | | |
|-----------------------------|--------|-------------|------|---|--------|-------|------------|------------|------------------------------|------|-------|---------|------------------|------|-------|-----------------|--|--|--------|---------------|------------|
| B | Use Co | Description | Zone | D | Fronta | Depth | Land Units | Unit Price | I. Fact | S.A. | Ac Di | C. Fact | St. Idx | Adj | Notes | Special Pricing | | | Size A | Adj Unit Pric | Land Value |
| 1 | 101 | ONE FAM | RC | | | | 12,000 SF | 9.32 | 1.000 | 5 | LAND | 1.00 | MA | 1.00 | | 0 | | | 1.000 | 9.32 | 111,800 |
| Total Card Land Units | | | | | | | 0.28 | AC | Parcel Total Land Area: 0.28 | | | | Total Land Value | | | | | | | 111,800 | |

| CONSTRUCTION DETAIL | | | CONSTRUCTION DETAIL (CONTINUED) | | |
|---------------------|------|-------------|---------------------------------|-------------|-------------|
| Element | Cd | Description | Element | Cd | Description |
| Style | 06 | COLONIAL | Basement Floor | 12 | CONCRETE |
| Model | 01 | RESIDENTIAL | Bsmt Garage | | |
| Grade | C+ | AVG. (+) | #Heat Sys | 1.00 | |
| Stories | 2.00 | 2 STORY | Units | 1 | |
| Foundation | 1 | CONCRETE | MIXED USE | | |
| Exterior Wall 1 | 4 | VINYL | Code | Description | Percentage |
| Exterior Wall 2 | | | 101 | ONE FAM | 100 |
| Roof Structure | 1 | GABLE | | | 0 |
| Roof Cover | 1 | ASPHALT SH | | | 0 |
| Interior Wall 1 | 1 | DRYWALL | COST / MARKET VALUATION | | |
| Interior Wall 2 | | | Adj Base Rate | | 122.88 |
| Interior Floor 1 | 3 | HARDWOOD | RCN | | 325,744 |
| Interior Floor 2 | 4 | CARPET | Net Other Adj | | |
| Heat Fuel | 2 | GAS | Year Built | | 2011 |
| Heat Type | 1 | FORCED H/A | Effective Year Built | | 2015 |
| AC Type | 03 | FULL | Depreciation Code | | GD |
| Bedrooms | 3 | | Remodel Rating | | |
| Full Baths | 2 | | Year Remodeled | | |
| Half Baths | 1 | | Depreciation % | | 6 |
| Extra Fixtures | 0 | | Functional Obsol | | |
| Total Rooms | 6 | | External Obsol | | |
| Bath Style | G | GOOD | Cost Trend Factor | | 1 |
| Half Bath Style | G | GOOD | Condition | | |
| Kitchens | 1 | | % Complete | | |
| Kitchen Style | G | GOOD | Overall % Condition | | 94 |
| Extra Kitchens | 0 | | RCNLD | | 306,200 |
| Extra Kitchen St | | | Dep % Ovr | | |
| FBM Sqft | | | Dep Ovr Comment | | |
| FBM Quality | | | Misc Imp Ovr | | |
| Fireplaces | 1 | | Misc Imp Ovr Comment | | |
| WS Flues | | | Cost to Cure Ovr | | |
| Central Vac | 1 | YES | Cost to Cure Ovr Comment | | |
| Frame | 1 | WOOD | | | |

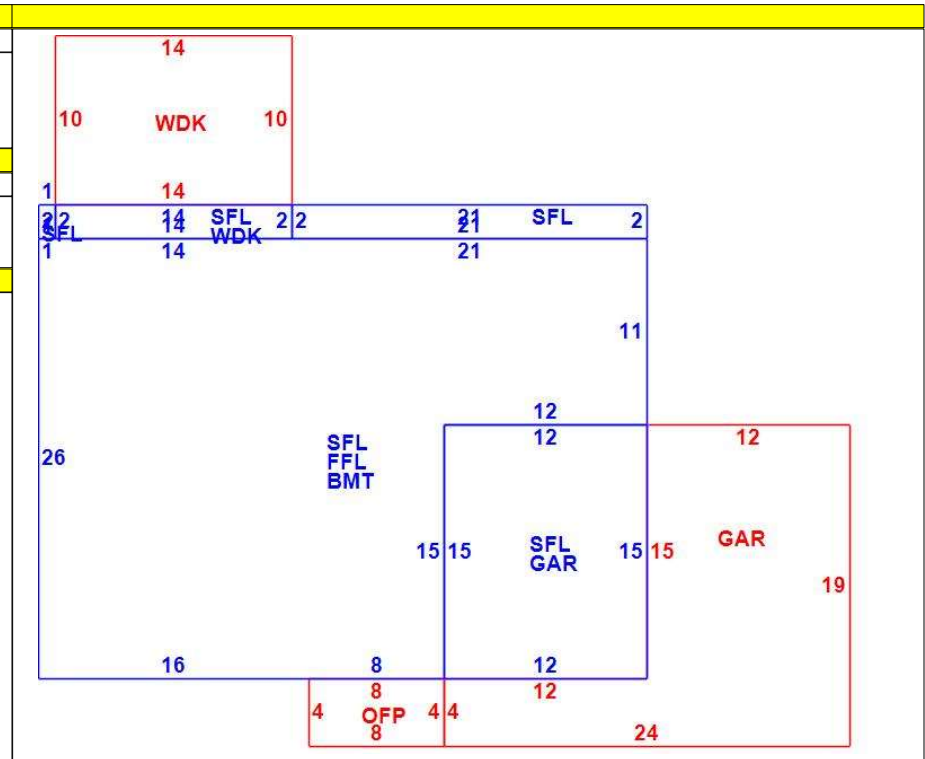

| OB - OUTBUILDING & YARD ITEMS(L) / XF - BUILDING EXTRA FEATURES(B) | | | | | | | | | | | | | |
|--|-------------|----|----------|-----|-------|------------|--------|----|------|------|-----|------|------------|
| Code | Description | Su | Sub Type | Lan | Units | Unit Price | Yr Blt | % | Dep. | Cond | Gra | Qual | Apprais Va |
| 02 | SHED/FR | | | L | 80 | 12.00 | 2018 | 60 | 0.00 | AV | A | 1.00 | 600 |
| 02 | SHED/FR | | | L | 120 | 12.00 | 2021 | 60 | 0.00 | AV | A | 1.00 | 900 |
| 19 | PATIO | | | L | 300 | 8.00 | 2018 | 60 | 0.00 | AV | A | 1.00 | 1,400 |

| BUILDING SUB-AREA SUMMARY SECTION | | | | | | |
|-----------------------------------|-------------|--------|-------|----------|-----------|----------------|
| Subarea | Description | Living | Gross | Eff Area | Unit Cost | Undeprec Value |
| BMT | BASEMENT | 0 | 756 | | 30.49 | 23,049 |
| FFL | 1ST FLOOR | 756 | 756 | | 152.64 | 115,399 |
| GAR | GARAGE | 0 | 456 | | 60.92 | 27,781 |
| OFF | OPEN PORCH | 0 | 32 | | 14.31 | 458 |
| SFL | 2ND FLOOR | 1,008 | 1,008 | | 152.64 | 153,866 |
| WDK | WOOD DECK | 0 | 168 | | 30.89 | 5,190 |
| Ttl Gross Liv / Lease Area | | 1,764 | 3,176 | | | 325,744 |

